

REIMBURSEMENT CONSIDERATIONS IN REHABILITATION TREATMENT SITES OF CARE

**WARNING: RISK OF SERIOUS HARM OR DEATH WITH INTRAVENOUS ADMINISTRATION;
SUBLOCADE RISK EVALUATION AND MITIGATION STRATEGY**

- Serious harm or death could result if administered intravenously. SUBLOCADE forms a solid mass upon contact with body fluids and may cause occlusion, local tissue damage, and thrombo-embolic events, including life threatening pulmonary emboli, if administered intravenously.
- Because of the risk of serious harm or death that could result from intravenous self-administration, SUBLOCADE is only available through a restricted program called the SUBLOCADE REMS Program. Healthcare settings and pharmacies that order and dispense SUBLOCADE must be certified in this program and comply with the REMS requirements.

Please see full [Prescribing Information](#), including **BOXED WARNING** and [Medication Guide](#), or go to SUBLOCADEHCP.com.

P-BAG-US-01101 EXPIRY March 2024

Sublocade[®]
(buprenorphine extended-release)
injection for subcutaneous use [®]
100mg•300mg

REIMBURSEMENT CONSIDERATIONS IN REHABILITATION TREATMENT SITES OF CARE

SUBLOCADE® (buprenorphine extended-release) can be administered across several different sites of care. Rehabilitation treatment centers (RTCs), which offer inpatient substance abuse treatment, are a common site of care for SUBLOCADE treatment. The following infographic highlights reimbursement considerations in this particular setting.

Coverage and Reimbursement Modalities for SUBLOCADE

PAYMENT VARIATION:
COVERAGE AND REIMBURSEMENT FOR SUBLOCADE WILL VARY ACROSS SITES OF CARE

Specific reimbursement of SUBLOCADE not only will depend on payer requirements but also acquisition options

BUNDLED PAYMENT

Residential drug and alcohol treatment centers typically offer a bundled, per diem payment for all services provided during the stay



MEDICAL VS. PHARMACY BENEFIT:

Reimbursement also depends on if the product is accessed via a health insurance plan's medical or pharmacy benefit



SUBLOCADE Reimbursement in RTC Based on Acquisition Channel

BUY-AND-BILL

Reimbursement for SUBLOCADE in the RTC site of care will vary by payer; payers may separately reimburse outside of the bundled payment while other payers may include in the bundle with other routine services



When separately reimbursable, SUBLOCADE will be billed as a separate line item from the per diem charge

When included in the bundled payment, no additional claim needs to be submitted for SUBLOCADE



SPECIALTY PHARMACY

Access for SUBLOCADE may be available through a specialty pharmacy and would not be included in the bundled payment to the RTC

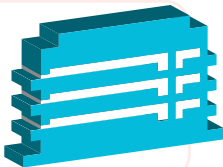

The specialty pharmacy will determine coverage for the patient and bill the payer for SUBLOCADE; if applicable, the HCP office will need to complete payer-specific PA forms to the patient's insurance provider

The RTC will only submit a claim for the per diem stay or agreed upon contract terms



Next Steps for Accessing SUBLOCADE in the RTC Site of Care

CONDUCT A THOROUGH BENEFIT INVESTIGATION:

Gain information from patient's health insurance plan to understand acquisition requirements, and claims submission information, specific to RTC sites of care either directly or through INSUPPORT

CONSULT THE RESOURCES ON THE INSUPPORT WEBSITE:

The website offers additional help; the SUBLOCADE Patient Journey Map details the access steps for patients including acquiring SUBLOCADE through a specialty pharmacy or distributor

CONTACT YOUR LOCAL PATIENT ACCESS SPECIALIST:

Your local Patient Access Specialist (PAS) may have more information regarding payer coverage and billing requirements

This information is provided for informational purposes only. Indivior does not guarantee coverage or reimbursement and it is the responsibility of the HCP to check with the payer.

IS YOUR PATIENT TRANSITIONING FROM AN RTC TO THE COMMUNITY?

If you have a patient transitioning to a new community provider to continue treatment with SUBLOCADE, INSUPPORT can provide you and your patient with information to support the next steps in the care continuum. See below to learn more about how INSUPPORT can help.



Locate a Community Provider

The first step in planning your patient's transition of care is identifying a provider or facility that can provide treatment with SUBLOCADE near your patient's address.



To find a treatment provider near your patient who is waived to provide SUBLOCADE, you can visit the Find a SUBLOCADE Treatment Provider Tool at www.INSUPPORT.com/specialty-product/transition-of-care.



Request Support

By enrolling your patient in Transition of Care Support, INSUPPORT can provide important information to support a successful transition process. Enroll your patient electronically at www.INSUPPORTportal.com or via the [INSUPPORT Patient Enrollment Form](#).



Coordinate an Appointment

Once you have determined the appropriate community provider for your patient, you can work with the patient to coordinate an initial appointment at the new site of care. INSUPPORT can provide a text reminder to the patient 3 calendar days prior to the appointment, if the patient requested text reminders on the enrollment form.



Prepare Your Patient

Prior to your patient's departure, ensure that the patient or caregiver is informed about next steps by providing contact information for the patient's new community provider, the patient's first appointment date and time, or the patient's next injection due date for SUBLOCADE, if scheduled.



Once the patient has left your care, INSUPPORT can continue to support the patient and new community provider with information on the access process for SUBLOCADE.

For more information about Transition of Care Support for SUBLOCADE, visit www.INSUPPORT.com or call INSUPPORT at **844-INSPPRT** (844-467-7778).

For **BOXED WARNING**, see front page. Please see full [Prescribing Information](#), including **BOXED WARNING** and [Medication Guide](#), or go to SUBLOCADEHCP.com.

For REMS information, visit www.SUBLOCADEREMS.com.

P-BAG-US-01101 EXPIRY March 2024

SUBLOCADE and INSUPPORT are registered trademarks of Indivior UK Limited.

© Indivior PLC | INDIVIOR is a registered trademark of Indivior UK Limited | All rights reserved.

Sublocade[®]
(buprenorphine extended-release)
injection for subcutaneous use [®]
100mg•300mg